

MEASURING GUIDE

All of our internal doors are supplied fully fabricated and glazed, but it is crucial that you measure your existing timber sub-frame correctly to ensure you order the correct sized door. This datasheet will show you how to do this and also enable you to consider how your door will be installed.

A SEPARATE DATASHEET IS AVAILABLE TO DEMONSTRATE HOW TO INSTALL AN INTERIOR DOOR.



Measuring your timber sub-frame

Firstly, when measuring any opening it is important to measure at 3 different points to ensure accuracy but also to check that the timber sub-frame is level and equal.

IMPORTANT NOTE: ALWAYS MEASURE THE SIDE OF THE FRAME YOU WANT YOUR NEW DOOR TO OPEN INTO.

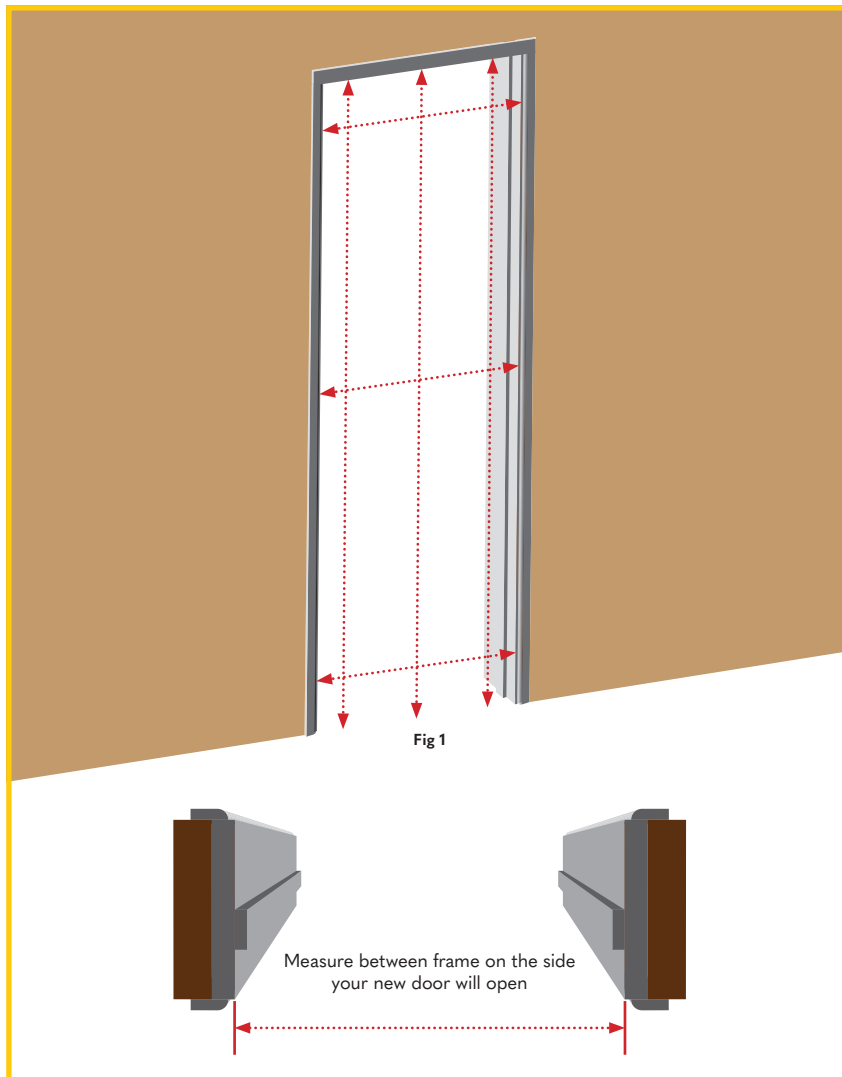

- A** Measure timber to timber, don't measure for the door slab size you think you need.
- B** Measure all the points as shown in illustration Fig 1.
- C** Height dimensions should be from finished floor level, allowing for any new flooring.
- D** Write your sizes in the chart below.
- E** Take the smallest dimension of the 3 and write it in the appropriate box.
- F** These are your tight frame sizes, to know what size frame to order:
 - I. Subtract 4mm from the minimum width dimension.
 - II. Subtract 3mm from the minimum height dimension.

Width

Width top	
Width middle	
Width bottom	
Minimum Width	
- 4 mm =	

Height

Height left	
Height middle	
Height right	
Minimum Height	
- 3 mm =	

Order your door at the smallest size or at the sizes marked in the yellow boxes above.