



# STANDARD SIZES



## Single Doors

**Single Door | £1152.00 ex VAT**  
700 x 1900mm - clear glass

**Single Door | £1184.00 ex VAT**  
800 x 2000mm - clear glass

**Single Door | £1230.00 ex VAT**  
900 x 2100mm - clear glass



## Double Doors

**Double Door | £2080.00 ex VAT**  
1200 x 1900mm - clear glass

**Double Door | £2240.00 ex VAT**  
1500 x 2000mm - clear glass

**Double Door | £2401.00 ex VAT**  
1800 x 2200mm - clear glass



## Glass Partition

**Glass Partition | £448.00 ex VAT**  
400 x 1900mm - clear glass

**Glass Partition | £632.00 ex VAT**  
800 x 2000mm - clear glass

**Glass Partition | £880.00 ex VAT**  
1000 x 2100mm - clear glass

**We manufacture to bespoke sizes and deliver nationwide**

# HANDING GUIDE

Our doors are designed specifically for internal use only. Your new Black Metal Door does not have to open the same as your existing door.

**TO DESIGN YOUR DOOR, YOU NEED TO SPECIFY THE HANDING, LEFT HAND OR RIGHT HAND.**

You need to stand outside of the room you want the new door to open into so that the door opens away from you.

## Choose your handing

Face the door so that the new door opens away from you, into the room you are facing.

Based on the images on the right determine the correct handing is based on the side of the door the hinges are.

## Example:

If you have a bedroom door that will open into the bedroom, stand in the hallway facing the bedroom door. The door should always open away from you.

The handing is the side the hinges are on as marked in the images to the right.

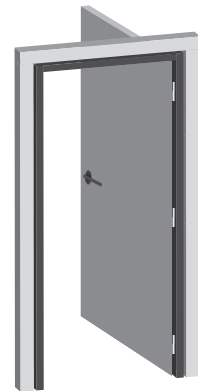

**RIGHT HAND**

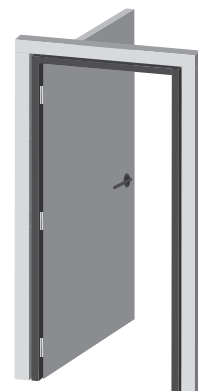

**LEFT HAND**



# MEASURING GUIDE

All of our internal doors are supplied fully fabricated and glazed, but it is crucial that you measure your existing timber sub-frame correctly to ensure you order the correct sized door. This datasheet will show you how to do this and also enable you to consider how your door will be installed.

**A SEPARATE DATASHEET IS AVAILABLE TO DEMONSTRATE HOW TO INSTALL AN INTERIOR DOOR.**



## Measuring your timber sub-frame

Firstly, when measuring any opening it is important to measure at 3 different points to ensure accuracy but also to check that the timber sub-frame is level and equal.

**IMPORTANT NOTE: ALWAYS MEASURE THE SIDE OF THE FRAME YOU WANT YOUR NEW DOOR TO OPEN INTO.**

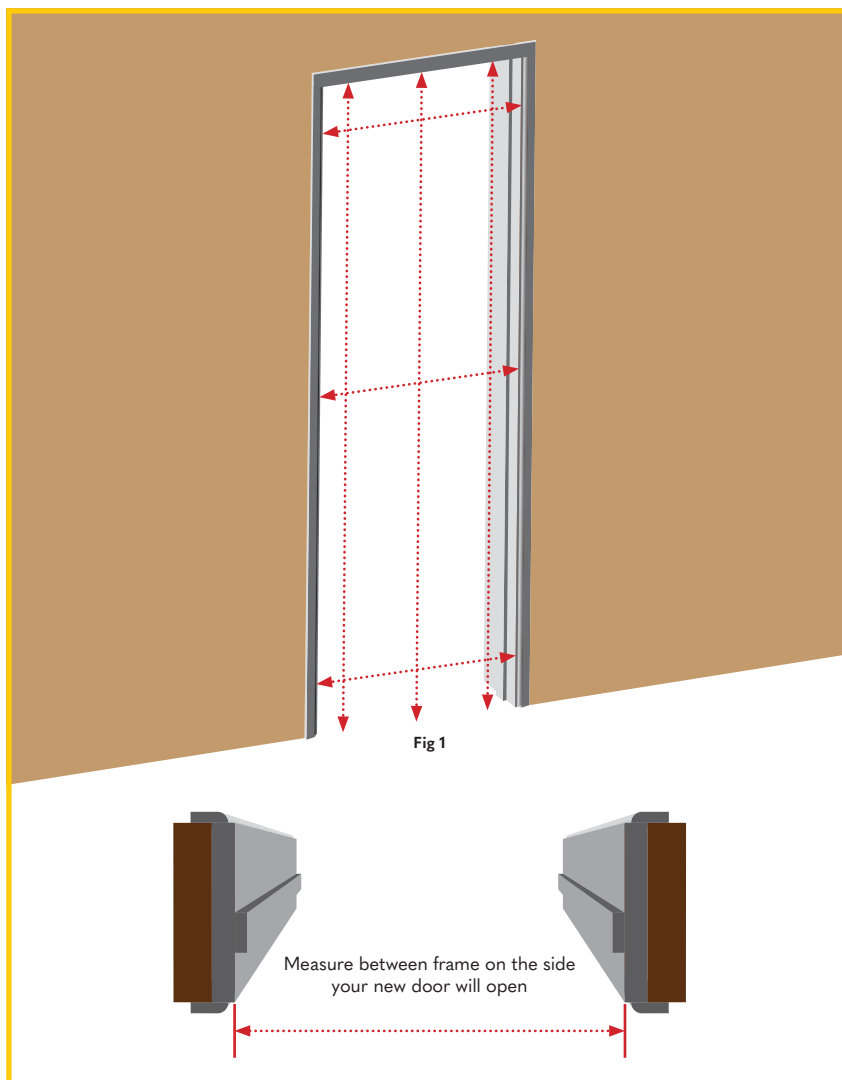

- A** Measure timber to timber, don't measure for the door slab size you think you need.
- B** Measure all the points as shown in illustration Fig 1.
- C** Height dimensions should be from finished floor level, allowing for any new flooring.
- D** Write your sizes in the chart below.
- E** Take the smallest dimension of the 3 and write it in the appropriate box.
- F** These are your tight frame sizes, to know what size frame to order:
  - I. Subtract 4mm from the minimum width dimension.
  - II. Subtract 3mm from the minimum height dimension.

### Width

Width top	
Width middle	
Width bottom	
<b>Minimum Width</b>	
- 4 mm =	

### Height

Height left	
Height middle	
Height right	
<b>Minimum Height</b>	
- 3 mm =	

Order your door at the smallest size or at the sizes marked in the yellow boxes above.

# INSTALLATION GUIDE

When you install your new Black Metal Door, you may need to remove the originally installed timber door slab. If this is the case, then you will need to remove the hinges and fixing plate from the door surround.

## TOOLS REQUIRED:



4mm drill & battery drill



Frame fixing screws



1mm Frame packers



Measuring Tape



Spirit Level



Chisel & hammer  
(if removing rebate)

**NOTE:** Frame fixing screw type and size depends on the material you are fixing the frame into. At the screw fixing points, the aluminium door frame body is 18mm thick.

- 1 Depending on the fixing method, you may need to fill in the recesses left in the timber. Use appropriate fillers and follow their instructions.

Fill-in the hinge and lock recesses to make frame flush, if required.

- 2 The next step is to determine the position of the aluminium door frame within your timber sub-frame. Firstly, the aluminium door frame should be positioned on the side of the sub-frame that the door will open into.

- 3 The majority of timber sub-frames have a rebate or central piece of rectangular timber positioned off-centre within the subframe. You can choose to keep or remove this (looks better removed!) If

you choose to keep it, then it will need to be positioned a minimum of 55mm from the edge (on the side the door opens into). Once re-positioned, position aluminium door frame hard up against the rebate.

- 4 Now it's time to check the position of the aluminium door frame on the timber sub-frame. For best results position the edge of the frame 3mm in from the edge of the timber sub-frame, this will create a neat finish and also allow the door hinges to open to their maximum opening angle. Setting the frame in the center of the sub-frame is also possible but it can restrict the opening angle of the door, please check this.

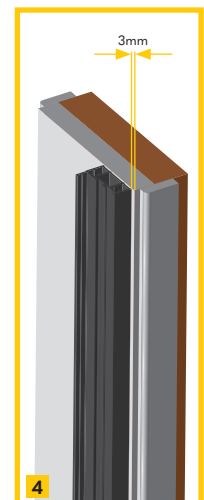
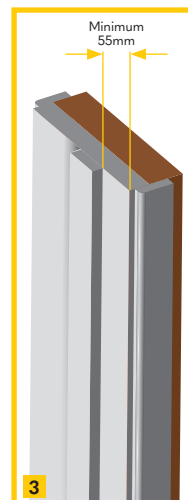

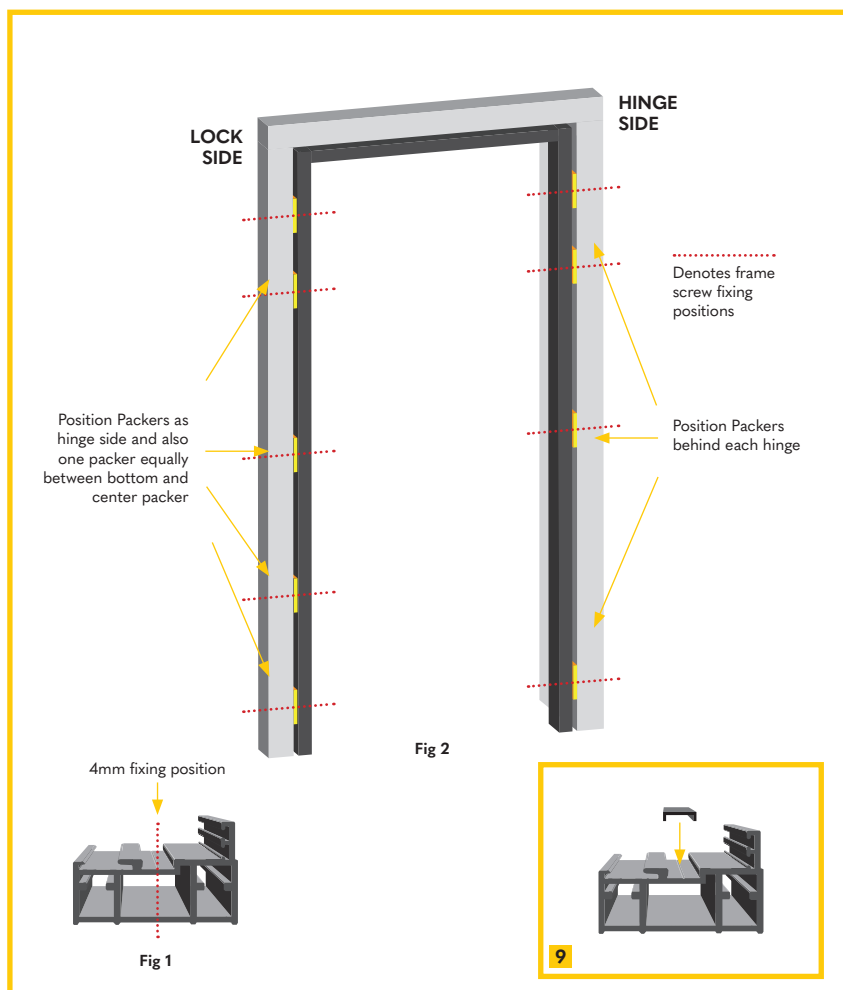

**5** Prior to positioning the aluminium door frame in the sub-frame you will need to drill the fixing hole positions in the aluminium door frame. Drill the 4mm hole in the frame recess (see Fig 1) directly next to each hinge and in the same position on the lock side. Furthermore, drill a hole 50mm above and below the keep plate. See packer position (Fig 2 for clarification of drilling positions. (drill positions denoted by .....).

**6** Measure the internal width of the timber frame and the overall outer-frame width of the door. Minus the door frame width from the timber sub-frame and then divide this by 2. This is the amount of clearance you will have between the frame and the timber sub-frame. Make this gap up with the 1mm packers.

**7** The bottom of the aluminium door frame is 12mm longer than the opening sash. Therefore, rest the aluminium door frame directly onto the finished floor level.

**8** Before fixing, check the frame is square and plumb. Then we recommend fixing the hinge side first. Then close the sash against the door frame on locking side and ensure the full length of the sash hits the aluminium door frame at the same time. Adjust position of door frame to ensure this happens. Start by fixing the centre screws above and below the keep, then top and bottom fixings.

**9** Ensure frame fixings are tight and do not bow the aluminium door frame. Check door operates correctly and then insert frame fixing strips to cover the screw heads. You may need to trim to size for perfect fit.





# BLACK METAL DOORS

